

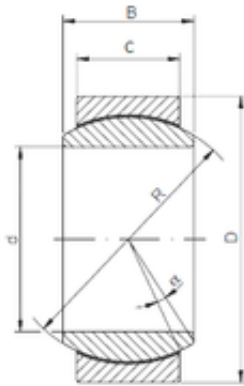

ISO GE 030 ECR-2RS plain bearings



Bearing No. GE 030 ECR-2RS

Size	30x47x22 mm
Bore Diameter	30 mm
Outer Diameter	47 mm
Width	22 mm
d	30 mm
D	47 mm
B	22 mm
C	18 mm
R	40,7 mm
Angle	6 °

GE 030 ECR-2RS Bearing 2D drawings and 3D CAD models